

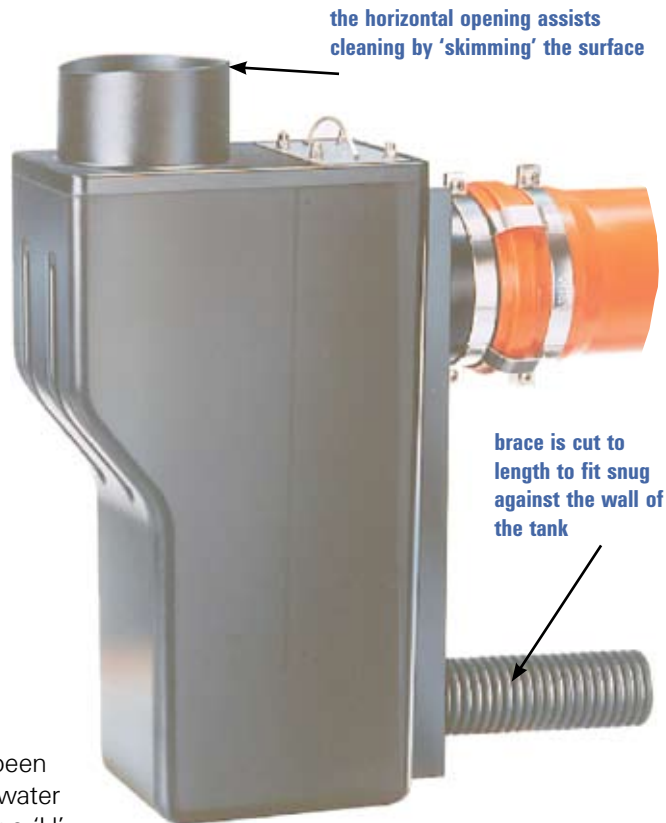

RAINWATER HARVESTING

MULTISIPHON OVERFLOW UNITS

- Fits standard 110mm pipe
- Horizontal opening maximises skimming effect
- Seals against unpleasant odours
- Polyethylene and stainless steel construction
- Manufactured by WISY
- Low maintenance
- Corrosion proof
- Optional anti-backflow device
- Optional anti-vermin device



The Multisiphon overflow unit has been designed specifically for use in rainwater storage tanks. The unit is effectively a 'U' bend, providing a water seal. This acts as a barrier to unpleasant smells from the drain that the connects to the overflow, which could otherwise taint the water.

The unit also performs the important function within the tank of removing the floating debris from the surface of the water. This is achieved by the design of the units' inlet, which is so shaped that when overflow conditions occur the water is 'skimmed' rapidly into the horizontal opening. This is important in keeping the tank clean and maintaining the quality of stored water.

The unit is supplied with an adjustable brace to stabilise the unit against the inside of the tank.

If water from the sewer flows back into the unit, the polyethylene ball float is forced against an O-ring, effectively sealing the tank against contamination

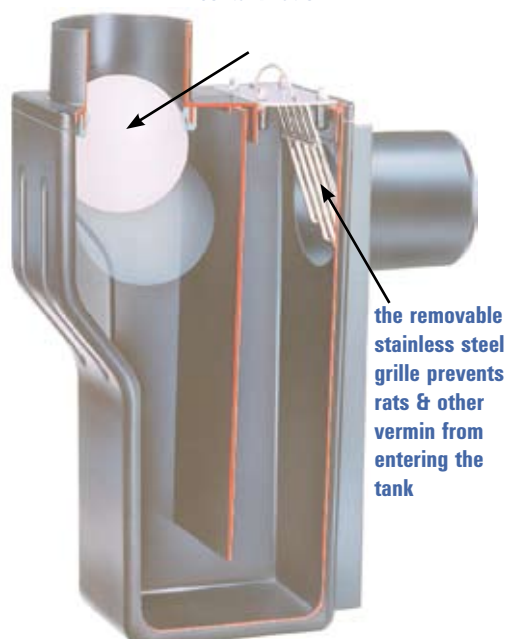

Article nos.

US1005
US1004
US1003
US1002

Mutisiphon trap
with backflow prevention
with vermin prevention
with vermin & backflow prevention



Model US1002 - for use where the tank must overflow to a sewer

TYPICAL TANK OVERFLOW INSTALLATION

(pump and pipework from tank to building omitted for clarity)

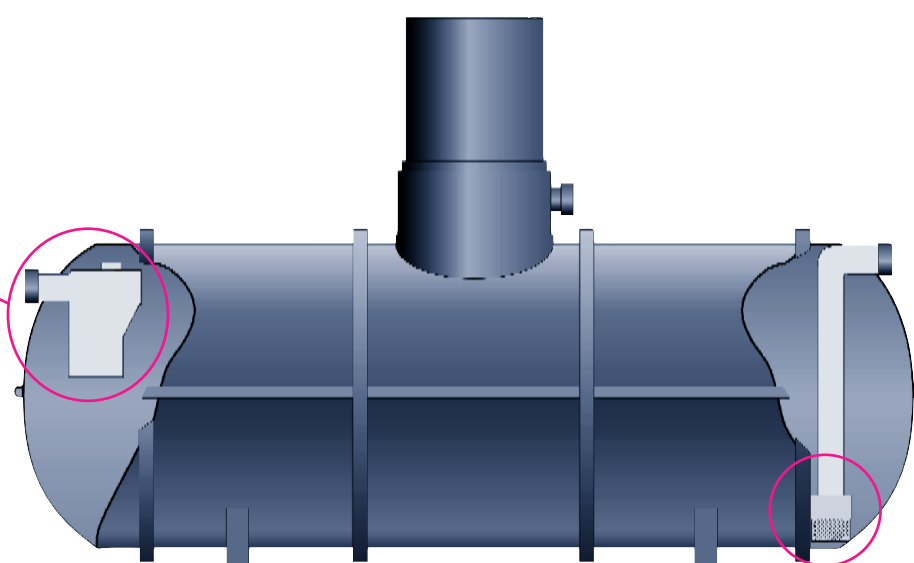
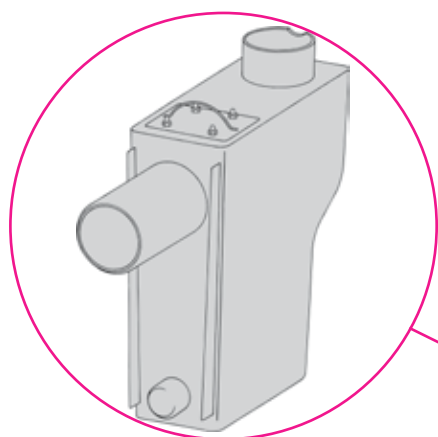

Rainsava water storage tanks can be supplied by us with Multisiphon overflow trap & smoothing inlet pre-fitted, thus saving on valuable installation time on site.

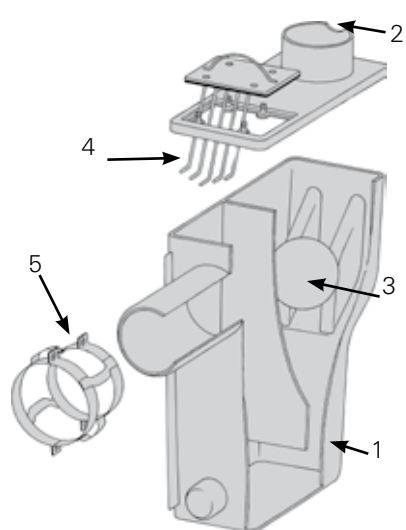

Model US1002 Component parts

- 1 - Main housing
- 2 - Shaped opening for skimming
- 3 - Ball float
- 4 - Vermin barrier, stainless steel
- 5 - Pipe clamp, stainless steel

The attention to detail in the design of any rainwater system is an important factor in its' performance and in the quality of the water produced.

Wisys 'Multisiphon' overflow traps and the 'smoothing inlet' have been designed to ensure water is stored under the best possible conditions. Like all Wisys products, these units have been developed specifically for use in rainwater harvesting systems.

SMOOTHING INLET

For installation in rainwater storage tanks

A stainless steel 'flow-calming' device to fit on to standard 110mm drainage pipe.

The unit is designed to eliminate turbulence of the incoming water as it enters the tank.

It is fitted to the open end of the inlet pipe at the base of the tank, which means that the fresh water enters from below the current water level.

The water thus gently percolates up from the base, causing no disturbance of the beneficial sediment layer in the base of the tank. Disturbance to any float switches or other controls are also minimised.

Article no. EB0300

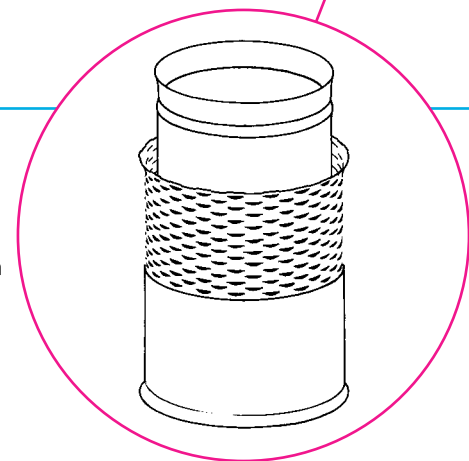

NB continuous development may necessitate change in these details without notice E&OE



Rainharvesting Systems Ltd.

The Green Shop
 Cheltenham Road, Bisley,
 Stroud, Gloucestershire GL6 7BX
 Tel: 0845 223 5430
 Fax: 01452 772008
 E-mail: sales@rainharvesting.co.uk
 Website: www.rainharvesting.co.uk

Distributor: